

STAMPE SV4C

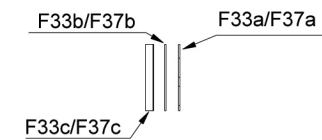

Percer l'emplacement des cadrans sur F33a et F37a. Contrecoller sur F33b et F37b. Le verre des cadrans est simulé par une goutte de vernis

L'ensemble sera ensuite collé sur les supports F33c et F37c

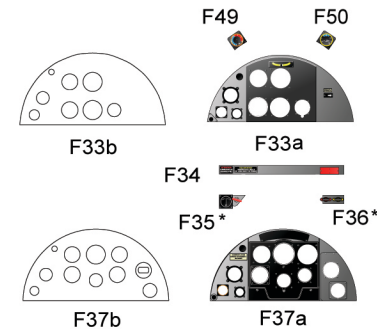
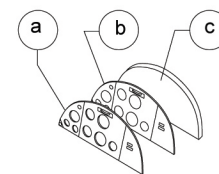
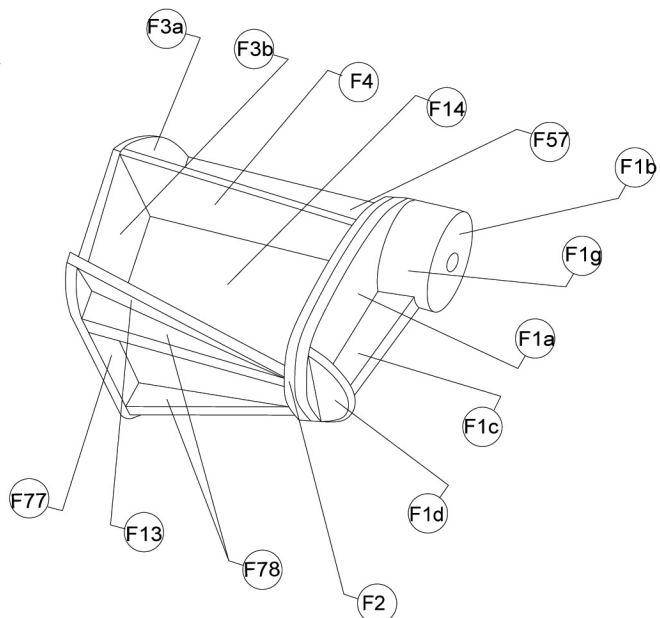
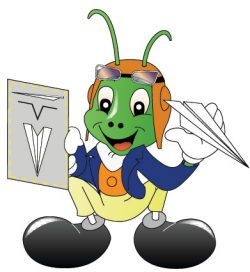
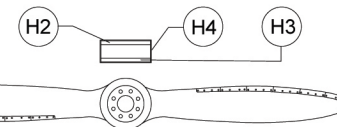
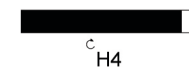

vue de face l'hélice tourne dans le sens anti-horaire

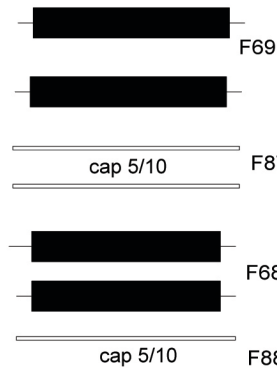
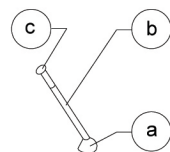
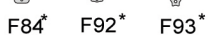
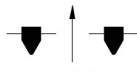
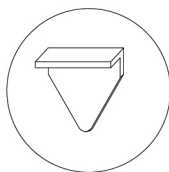
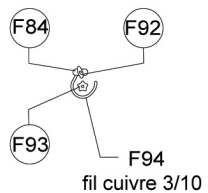
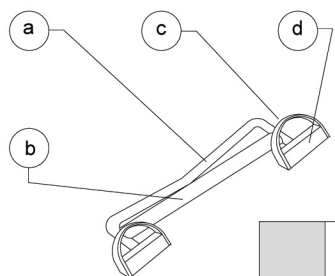

La longueur des mats est à ajuster au montage (mise en croix).

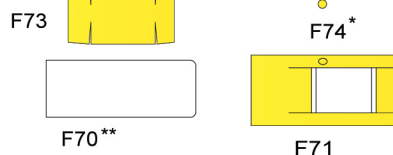

A25

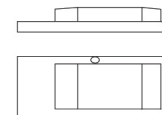
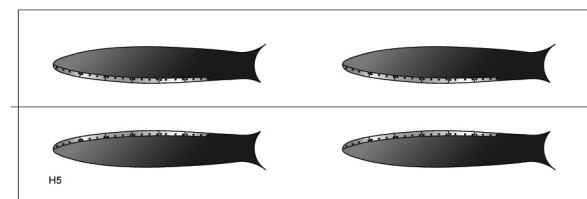

plan 3 vues
réservoir huile

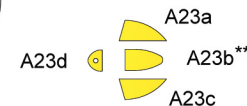
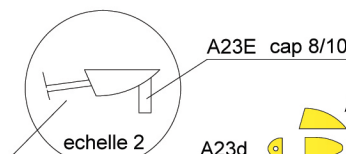

fil de cuivre 8/10. voir cheminement sur photos



conception Philippe RENNESSON 2012
mise en couleur Alban DURY 2012

<http://www.criquet.over-blog.com>

Le hangar aux souvenirs

Toute reproduction, modification, même partielle, autre qu'à l'usage purement privé et sans l'accord de l'auteur est interdite.